



Tel: 505-550-6501
Fax: 505-814-5778
Email: sales@agstech.net
Web: www.agstech.net

PRIVATE LABEL OPTION OEM OPTION



A I R C O N T R O L

We can put your company name, brand....on these



HOSES AND FITTINGS

FOR COMPRESSED AIR | MADE IN DENMARK



Hoses and fittings for compressed air



PNEUMATIC RECOIL HOSES PA12

Robust and withstands sunlight. With fittings, plastic or metal reliefs and swivel.

4



RECOIL HOSES PUR - FLEX BOY

Flexible and oil-resistant hose. With fittings, reliefs or as ready-to-use set with blow gun.

5



RECOIL HOSES PUR - FLEX BOY

Flexible and oil-resistant hose. With quick connect coupling and euro nipple or with blow gun.

7



RECOIL HOSES PUR BLACK

Super flexible and oil-resistant recoil hoses with fittings.

8



FRL UNITS

Protect tools and equipment from moisture and impurities.

8



SOFT PVC HOSES

Heavy-duty, reinforced and pressure-resistant. As loose hoses or with couplings and euro nipple.

9



FITTINGS

Fittings for compressed air systems.

10

GET TOOLS, BLOW GUNS, HOSES AND COUPLINGS AS PRIVATE LABEL

If you like to have your own private label products for compressed air, then you can get all these products as private label. You can adjust colour, engraving, shape, etc. to make it your own look.

Pneumatic recoil hoses PA12

Nylon recoil hoses is particular suitable for environments that require robust pneumatic hoses. The hoses are resistant to pressure and high/low temperatures. They have an excellent ability to retain their coiled form. Withstands continuous sunlight.

Technical description

| | |
|------------------|----------------------|
| Material | Polyamide 12 (PA12) |
| Working pressure | Max. 25 bar at 23 °C |
| Temp. range | -40 °C to +100 °C |
| Surface hardness | Shore D63 |



1700208-05
Recoil hose PA12 with metal relief spring, swivel joint and fittings.



1700512-05
Recoil hose PA12 with fittings and plastic relief spring.

Recoil hose PA12 with metal relief spring, swivel joint & fittings

| Connection | Dimension | Work length | Max. work pressure | Art. No. |
|---------------------------|---------------|-------------|--------------------|--------------|
| 1/4" BSPT external thread | ø6 x ø8 mm | 2.5 m | 25 bar | 1700208-02 |
| 1/4" BSPT external thread | ø6 x ø8 mm | 3.5 m | 25 bar | 1700208-03 |
| 1/4" BSPT external thread | ø6 x ø8 mm | 5 m | 25 bar | 1700208-05 |
| 1/4" BSPT external thread | ø6 x ø8 mm | 7.5 m | 25 bar | 1700208-07 |
| 1/4" BSPT external thread | ø6 x ø8 mm | 10 m | 25 bar | 1700208-10 * |
| 1/4" BSPT external thread | ø6 x ø8 mm | 15 m | 25 bar | 1700208-15 * |
| 1/4" BSPT external thread | ø7,5 x ø10 mm | 3 m | 25 bar | 1700410-03 |
| 1/4" BSPT external thread | ø7,5 x ø10 mm | 7.5 m | 25 bar | 1700410-07 |

Recoil hose PA 12 with fittings & plastic relief spring

| Connection | Dimension | Work length | Max. work pressure | Art. No. |
|---------------------------|------------|-------------|--------------------|--------------|
| 3/8" BSPT external thread | ø9 x 12 mm | 5 m | 25 bar | 1700512-05 * |
| 3/8" BSPT external thread | ø9 x 12 mm | 7.5 m | 25 bar | 1700512-07 * |
| 3/8" BSPT external thread | ø9 x 12 mm | 10 m | 25 bar | 1700512-10 * |

* Special order item. Expected delivery time minimum 7 weeks. MOQ 25 units.

Recoil hoses PUR - Flex Boy

Very flexible recoil hoses that are capable of bending without being damaged. Maintains persistent flexibility at temperatures as low as -40 °C. An oil-resistant hose whose superior qualities are acknowledged in all sectors of industry. We recommend that polyurethane hoses do not be used in direct sunlight for long periods of time.

Technical description

| | |
|------------------|-----------------------|
| Material | Polyurethane |
| Working pressure | Max. 10 bar at +20 °C |
| Temp. range | -40 °C to +60 °C |
| Surface hardness | Shore D52 |



1710410-04
Recoil hose PUR with fittings.



1710512-04
Recoil hose PUR with fittings and plastic relief spring.

Recoil hose PUR - Flex Boy with fittings

| Connection | Dimension | Work length | Max. work pressure | Art. No. |
|---------------------------|---------------|-------------|--------------------|-------------|
| 1/4" BSPT external thread | ø4 x ø6 mm | 1 m | 10 bar | 1710206-01* |
| 1/4" BSPT external thread | ø4 x ø6 mm | 2 m | 10 bar | 1710206-02* |
| 1/4" BSPT external thread | ø4 x ø6 mm | 4 m | 10 bar | 1710206-04* |
| 1/4" BSPT external thread | ø5 x ø8 mm | 2 m | 10 bar | 1710208-02 |
| 1/4" BSPT external thread | ø5 x ø8 mm | 4 m | 10 bar | 1710208-04 |
| 1/4" BSPT external thread | ø5 x ø8 mm | 6 m | 10 bar | 1710208-06 |
| 1/4" BSPT external thread | ø5 x ø8 mm | 8 m | 10 bar | 1710208-08 |
| 3/8" BSPT external thread | ø6.5 x ø10 mm | 2 m | 10 bar | 1710410-02* |
| 3/8" BSPT external thread | ø6.5 x ø10 mm | 4 m | 10 bar | 1710410-04* |
| 3/8" BSPT external thread | ø6.5 x ø10 mm | 6 m | 10 bar | 1710410-06* |
| 3/8" BSPT external thread | ø6.5 x ø10 mm | 8 m | 10 bar | 1710410-08* |

Recoil hose PUR - Flex BOY with fittings & plastic relief spring

| Connection | Dimension | Work length | Max. work pressure | Art. No. |
|---------------------------|------------|-------------|--------------------|--------------|
| 3/8" BSPT external thread | ø8 x 12 mm | 4 m | 10 bar | 1710512-04 |
| 3/8" BSPT external thread | ø8 x 12 mm | 6 m | 10 bar | 1710512-06 * |
| 3/8" BSPT external thread | ø8 x 12 mm | 8 m | 10 bar | 1710512-08 * |

Ready to use Flex Boy recoil hose with Air Boy® Classic blow gun

| Connection | Dimension | Work length | Max. work pressure | Art. No. |
|---------------------------|---------------------------------|-------------|--------------------|--------------|
| 1/4" BSPT external thread | ø5 x ø8 mm and Air Boy® Classic | 2 m | 10 bar | 242802-000 |
| 1/4" BSPT external thread | ø5 x ø8 mm and Air Boy® Classic | 4 m | 10 bar | 242804-000 * |
| 1/4" BSPT external thread | ø5 x ø8 mm and Air Boy® Classic | 6 m | 10 bar | 242806-000 * |

* Special order item. Expected delivery time minimum 7 weeks. MOQ 25 units.

Ready to use recoil hose with series 530 quick connect coupling and Air Boy Classic blow gun with 8 mm bent pipe.

Art. No. 240806-000530



Recoil hoses PUR - Flex Boy

Very flexible recoil hoses that are capable of bending without being damaged. Maintains persistent flexibility at temperatures as low as -40 °C. An oil-resistant hose with superior qualities that are acknowledged in all sectors of industry.

We recommend not to use polyurethane hoses in direct sunlight for long periods of time.

Technical description

| | |
|------------------|-----------------------|
| Material | Polyurethane |
| Working pressure | Max. 10 bar at +20 °C |
| Temp. range | -40 °C to +60 °C |
| Surface hardness | Shore D52 |



1810410-04530
Recoil hose PUR with series 530 quick connect coupling and euro nipple.



240806-000530
Ready-to-use Flex Boy recoil hose with heavy duty series 530 quick connect coupling, euro nipple and Air Boy Classic blow gun.

Recoil hoses PUR -Flex Boy with Series 530 quick connect coupling & euro nipple

| Connection | Dimension | Work length | Max. work pressure | Art. no. |
|---|---------------|-------------|--------------------|----------------|
| Series 530 quick connect coupling and euro nipple | ø5 x ø8 mm | 1 m | 10 bar | 1810208-01530* |
| Series 530 quick connect coupling and euro nipple | ø5 x ø8 mm | 2 m | 10 bar | 1810208-02530 |
| Series 530 quick connect coupling and euro nipple | ø5 x ø8 mm | 4 m | 10 bar | 1810208-04530* |
| Series 530 quick connect coupling and euro nipple | ø5 x ø8 mm | 6 m | 10 bar | 1810208-06530 |
| Series 530 quick connect coupling and euro nipple | ø5 x ø8 mm | 8 m | 10 bar | 1810208-08530* |
| Series 530 quick connect coupling and euro nipple | ø6.5 x ø10 mm | 2 m | 10 bar | 1810410-02530 |
| Series 530 quick connect coupling and euro nipple | ø6.5 x ø10 mm | 4 m | 10 bar | 1810410-04530 |
| Series 530 quick connect coupling and euro nipple | ø6.5 x ø10 mm | 6 m | 10 bar | 1810410-06530 |
| Series 530 quick connect coupling and euro nipple | ø6.5 x ø10 mm | 8 m | 10 bar | 1810410-08530 |
| Series 530 quick connect coupling and euro nipple | ø8 x ø12 mm | 2 m | 10 bar | 1810512-02530 |
| Series 530 quick connect coupling and euro nipple | ø8 x ø12 mm | 4 m | 10 bar | 1810512-04530 |
| Series 530 quick connect coupling and euro nipple | ø8 x ø12 mm | 6 m | 10 bar | 1810512-06530 |
| Series 530 quick connect coupling and euro nipple | ø8 x ø12 mm | 8 m | 10 bar | 1810512-08530* |

Flex Boy recoil hose with Air Boy Classic blow gun, 530 quick connect coupling & euro nipple

| Connection | Dimension | Work length | Max. work pressure | Art. no. |
|--|------------|-------------|--------------------|---------------|
| Series 530 quick connect coupling, euro nipple & Air Boy | ø5 x ø8 mm | 4 m | 10 bar | 240802-000530 |
| Series 530 quick connect coupling, euro nipple & Air Boy | ø5 x ø8 mm | 4 m | 10 bar | 240804-000530 |
| Series 530 quick connect coupling, euro nipple & Air Boy | ø5 x ø8 mm | 6 m | 10 bar | 240806-000530 |

* Special order item. Expected delivery time minimum 7 weeks. MOQ 25 units.

Recoil hoses PUR black

Very flexible recoil hoses that are capable of bending without being damaged. Maintains persistent flexibility at temperatures as low as -40 °C. An oil-resistant hose with superior qualities that are acknowledged in all industry sectors. We recommend not to use polyurethane hoses in direct sunlight for long periods of time.



1750410-04
Black recoil hose PUR with fittings.

Technical description

| | |
|------------------|----------------------|
| Material | Polyamide 12 (PA12) |
| Working pressure | Max. 10 bar at 20 °C |
| Temp. range | -40 °C to +80 °C |

Black recoil hoses PUR with fittings

| Connection | Dimension | Work length | Max. work pressure | Art. No. |
|---------------------------|---------------|-------------|--------------------|-------------|
| 1/4" BSPT external thread | ø5 x ø8 mm | 2 m | 10 bar | 1750208-02* |
| 1/4" BSPT external thread | ø5 x ø8 mm | 4 m | 10 bar | 1750208-04 |
| 1/4" BSPT external thread | ø5 x ø8 mm | 6 m | 10 bar | 1750208-06 |
| 1/4" BSPT external thread | ø5 x ø8 mm | 8 m | 10 bar | 1750208-08 |
| 3/8" BSPT external thread | ø6.5 x ø10 mm | 2 m | 10 bar | 1750410-02* |
| 3/8" BSPT external thread | ø6.5 x ø10 mm | 4 m | 10 bar | 1750410-04* |
| 3/8" BSPT external thread | ø6.5 x ø10 mm | 6 m | 10 bar | 1750410-06 |
| 3/8" BSPT external thread | ø6.5 x ø10 mm | 8 m | 10 bar | 1750410-08* |
| 1/2" BSPT external thread | ø8 x ø12 mm | 4 m | 10 bar | 1750512-04* |
| 1/2" BSPT external thread | ø8 x ø12 mm | 6 m | 10 bar | 1750512-06* |

* Special order item. Expected delivery time minimum 7 weeks. MOQ 25 units.

FRL Units

To protect tools and equipment from moisture and impurities a FRL unit should be placed before them. FRL units are compact devices that filter, pressure regulate and separate fluid and particles from the compressed air (FRL = Filter-Regulator-Lubricator). The FRL units are available either as regulator with a water separator (334381) or a regulator with water separator and lubricator (334386). Both models come with mounting brackets.



334381
Regulator with water separator.



334386
Regulator with water separator and lubricator.

Specifications and materials

| | |
|------------------------------|-------------------------|
| Working pressure | <10 bar (145 psi) |
| Guaranteed maximum pressure | 15 bar (218 psi) |
| Temperature range | +5 °C to +60 °C |
| Filter Size | 25 µm |
| Recommended oil (lubricator) | Turbine No1 Oil ISOVG32 |
| Pressure regulation range | 0.5 to 8.5 bar |

| | |
|--|-----------------|
| Valve Type | Overflow |
| Air consumption at p1=7 Bar & p2=5 Bar | 500 l/min. |
| Connections | 1/4"BSPT thread |
| Pressure gauge | G36-10-01 |
| Weight (334381/334386) | 353 g / 581 g |
| Container made of | Polycarbonat |

Flow

Bar / l/min.

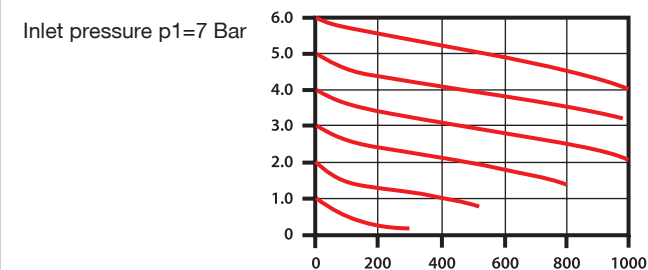

Flow

Bar / bar

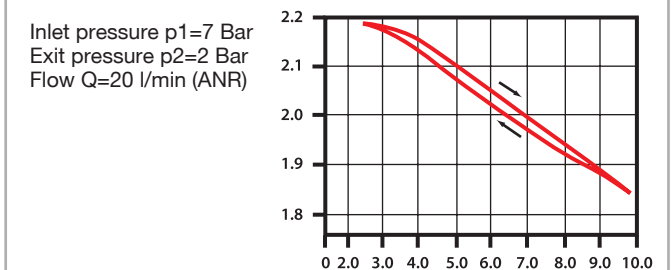

Soft PVC pneumatic hoses

Super flexible pneumatic hoses, ideal for most pneumatic installations.

A robust, heavy-duty, reinforced, pressure-resistant hose. Please note that lengths of the PVC hoses can vary +/- 5%.



1710512-04

Recoil hose PUR with fittings and plastic relief spring.

Technical description

| | |
|------------------|-----------------------|
| Material | 3 layers PVC |
| Working pressure | Max. 15 bar at +20 °C |
| Temp. range | -20 °C to +60 °C |
| Reinforcement | Polyester fiber |

Reinforced soft PVC hose with series 520 quick connect coupling & euro nipple

| Connection | Dimension | Work length | Max. work pressure | Art. No. |
|---|--------------|-------------|--------------------|---------------|
| Series 520 quick connect coupling & euro nipple | ø6.3 x 11 mm | 5 m | 15 bar | 1761002-05520 |
| Series 520 quick connect coupling & euro nipple | ø6.3 x 11 mm | 10 m | 15 bar | 1761002-10520 |
| Series 520 quick connect coupling & euro nipple | ø6.3 x 11 mm | 15 m | 15 bar | 1761002-15520 |
| Series 520 quick connect coupling & euro nipple | ø6.3 x 11 mm | 20 m | 15 bar | 1761002-20520 |
| Series 520 quick connect coupling & euro nipple | ø9 x 14.5 mm | 5 m | 15 bar | 1761004-05520 |
| Series 520 quick connect coupling & euro nipple | ø9 x 14.5 mm | 10 m | 15 bar | 1761004-10520 |
| Series 520 quick connect coupling & euro nipple | ø9 x 14.5 mm | 15 m | 15 bar | 1761004-15520 |
| Series 520 quick connect coupling & euro nipple | ø9 x 14.5 mm | 20 m | 15 bar | 1761004-20520 |

Reinforced soft PVC hose with series 530 quick connect coupling & euro nipple

| Connection | Dimension | Work length | Max. work pressure | Art. No. |
|---|--------------|-------------|--------------------|---------------|
| Series 530 quick connect coupling & euro nipple | ø6.3 x 11 mm | 5 m | 15 bar | 1761002-05530 |
| Series 530 quick connect coupling & euro nipple | ø6.3 x 11 mm | 10 m | 15 bar | 1761002-10530 |
| Series 530 quick connect coupling & euro nipple | ø6.3 x 11 mm | 15 m | 15 bar | 1761002-15530 |
| Series 530 quick connect coupling & euro nipple | ø6.3 x 11 mm | 20 m | 15 bar | 1761002-20530 |
| Series 530 quick connect coupling & euro nipple | ø9 x 14.5 mm | 5 m | 15 bar | 1761004-05530 |
| Series 530 quick connect coupling & euro nipple | ø9 x 14.5 mm | 10 m | 15 bar | 1761004-10530 |
| Series 530 quick connect coupling & euro nipple | ø9 x 14.5 mm | 15 m | 15 bar | 1761004-15520 |
| Series 530 quick connect coupling & euro nipple | ø9 x 14.5 mm | 20 m | 15 bar | 1761004-20530 |

Reinforced soft PVC Hoses

| Connection | Dimension | Work length | Max. work pressure | Art. No. |
|---------------------------|---------------|-------------|--------------------|------------|
| No connection - only hose | ø6.3 x 11 mm | 50 m | 15 bar | 1761002-50 |
| No connection - only hose | ø9 x 14.5 mm | 50 m | 15 bar | 1761004-50 |
| No connection - only hose | ø12.7 x 19 mm | 50 m | 15 bar | 1761006-50 |

Hose clamps

| Dimension | Art. No. |
|-----------------------|----------|
| Hose clamp (7-9 mm) | 1490709 |
| Hose clamp (9-11 mm) | 1490911 |
| Hose clamp (11-13 mm) | 1491113 |
| Hose clamp (13-15 mm) | 1491315 |
| Hose clamp (15-18 mm) | 1491518 |
| Hose clamp (17-20 mm) | 1491720 |

Fittings

Our Fittings comprise a wide range of connectors and accessories for your compressed-air installations.

Free angle fittings



| Dimension | Art. No. |
|--|----------|
| Coupler plug (Euro) x 1/4" internal thread | 443302 |
| Coupler plug (Euro) x 1/4" external thread | 443312 |
| 1/4" internal x 1/4" internal thread | 440202 |
| 1/4" external x 1/4" internal thread | 441202 |
| 3/8" external x 3/8" internal thread | 441404 |
| 1/4" hose connection x 1/4" external thread | 442202 |
| 3/8" hose connection x 1/4" external thread | 442412 |
| 3/8" hose connection x 3/8" external thread | 442414 |
| PUR connection $\varnothing 5/\varnothing 8$ mm x 1/4" external thread | 440812 |
| PUR connection $\varnothing 6,5/\varnothing 10$ mm x 1/4" ext. thread | 441012 |



Hose connectors

| Dimension | Art. No. |
|-------------------------------------|----------|
| 3/16" - 5 mm x 1/4" external thread | 625002 |
| 1/4" - 6 mm x 1/8" external thread | 625020 |
| 1/4" - 6 mm x 1/4" external thread | 625022 |
| 1/4" - 6 mm x 3/8" external thread | 625024 |
| 1/4" - 6 mm x 1/2" external thread | 625025 |
| 5/16" - 8 mm x 1/4" external thread | 625032 |
| 5/16" - 8 mm x 3/8" external thread | 625034 |
| 5/16" - 8 mm x 1/2" external thread | 625035 |
| 3/8" - 10 mm x 1/4" external thread | 625042 |
| 3/8" - 10 mm x 3/8" external thread | 625044 |
| 3/8" - 10 mm x 1/2" external thread | 625045 |
| 1/2" - 13 mm x 1/4" external thread | 625052 |
| 1/2" - 13 mm x 3/8" external thread | 625054 |
| 1/2" - 13 mm x 1/2" external thread | 625055 |
| 1/2" - 13 mm x 3/4" external thread | 625057 |
| 3/4" - 20 mm x 3/8" external thread | 625074 |
| 3/4" - 20 mm x 3/4" external thread | 625077 |
| 1/4" - 6 mm x 1/8" internal thread | 626020 |
| 1/4" - 6 mm x 1/4" internal thread | 626022 |
| 1/4" - 6 mm x 3/8" internal thread | 626024 |
| 5/16" - 8 mm x 1/4" internal thread | 626032 |
| 3/8" - 10 mm x 1/4" internal thread | 626042 |
| 3/8" - 10 mm x 3/8" internal thread | 626044 |
| 3/8" - 10 mm x 1/2" internal thread | 626045 |
| 1/2" - 13 mm x 1/4" internal thread | 626052 |
| 1/2" - 13 mm x 3/8" internal thread | 626054 |
| 1/2" - 13 mm x 1/2" internal thread | 626055 |

Hose connectors



| Dimension | Art. No. |
|-----------------------------|----------|
| 1/4" (6 mm) x 1/4" (6 mm) | 621022 |
| 5/16" (8 mm) x 5/16" (8 mm) | 621033 |
| 3/8" (10 mm) x 3/8" (10 mm) | 621044 |
| 1/2" (12 mm) x 1/2" (12 mm) | 621055 |

X-pieces



| Dimension | Art. No. |
|--------------------------|----------|
| 4 x 1/8" internal thread | 628000 |
| 4 x 1/4" internal thread | 628022 |
| 4 x 3/8" internal thread | 628044 |
| 4 x 1/2" internal thread | 628055 |

Y-pieces



| Dimension | Art. No. |
|--|----------|
| 1/8" x 1/8" x 1/8" internal thread | 627000 |
| 1/4" x 1/4" x 1/4" internal thread | 627022 |
| 3/8" x 3/8" x 3/8" internal thread | 627044 |
| 1/2" x 1/2" x 1/2" internal thread | 627055 |
| 1/8" external x 1/8" internal x 1/8" internal thread | 627200 |
| 1/4" external x 1/4" internal x 1/4" internal thread | 627222 |
| 3/8" external x 3/8" internal x 3/8" internal thread | 627244 |
| 1/2" external x 1/2" internal x 1/2" internal thread | 627255 |

T-pieces



| Dimension | Art. No. |
|--|----------|
| 1/8" x 1/8" x 1/8" internal thread | 630000 |
| 1/4" x 1/4" x 1/4" internal thread | 630022 |
| 3/8" x 3/8" x 3/8" internal thread | 630044 |
| 1/2" x 1/2" x 1/2" internal thread | 630055 |
| 1/8" external x 1/8" internal x 1/8" internal thread | 630200 |
| 1/4" external x 1/4" internal x 1/4" internal thread | 630222 |
| 3/8" external x 3/8" internal x 3/8" internal thread | 630244 |
| 1/2" external x 1/2" internal x 1/2" internal thread | 630255 |



L-pieces

| Dimension | Art. No. |
|--------------------------------------|----------|
| 1/8" internal x 1/8" internal thread | 623000 |
| 1/4" internal x 1/4" internal thread | 623022 |
| 3/8" internal x 3/8" internal thread | 623044 |
| 1/2" internal x 1/2" internal thread | 623055 |
| 3/4" internal x 3/4" internal thread | 623077 |
| 1/8" external x 1/8" external thread | 623100 |
| 1/4" external x 1/4" external thread | 623122 |
| 3/8" external x 3/8" external thread | 623144 |
| 1/2" external x 1/2" external thread | 623155 |
| 1/8" external x 1/8" internal thread | 623200 |
| 1/4" external x 1/4" internal thread | 623222 |
| 3/8" external x 3/8" internal thread | 623244 |
| 1/2" external x 1/2" internal thread | 623255 |
| 3/4" external x 3/4" internal thread | 623277 |



Ball cocks

| Dimension | Art. No. |
|---|----------|
| 1/4" internal thread x 1/4" internal thread | 631022 |
| 3/8" internal thread x 3/8" internal thread | 631044 |
| 1/2" internal thread x 1/2" internal thread | 631055 |
| 1/4" external thread x 1/4" internal thread | 631222 |
| 3/8" external thread x 3/8" internal thread | 631244 |
| 1/2" external thread x 1/2" internal thread | 631255 |



Adaptors

| Dimension | Art. No. |
|--------------------------------------|----------|
| 1/8" external x 1/8" external thread | 624000 |
| 1/8" external x 1/4" external thread | 624002 |
| 1/8" external x 3/8" external thread | 624004 |
| 1/4" external x 1/4" external thread | 624022 |
| 1/4" external x 3/8" external thread | 624024 |
| 1/4" external x 1/2" external thread | 624025 |
| 3/8" external x 3/8" external thread | 624044 |
| 3/8" external x 1/2" external thread | 624045 |
| 1/2" external x 1/2" external thread | 624055 |
| 1/2" external x 3/4" external thread | 624057 |
| 3/4" external x 3/4" external thread | 624077 |



Sockets

| Dimension | Art. No. |
|---|----------|
| 1/8" internal thread x 1/8" internal thread | 629000 |
| 1/8" internal thread x 1/4" internal thread | 629002 |
| 1/8" internal thread x 3/8" internal thread | 629004 |
| 1/4" internal thread x 1/4" internal thread | 629022 |
| 1/4" internal thread x 3/8" internal thread | 629024 |
| 1/4" internal thread x 1/2" internal thread | 629025 |
| 3/8" internal thread x 3/8" internal thread | 629044 |
| 3/8" internal thread x 1/2" internal thread | 629045 |
| 1/2" internal thread x 1/2" internal thread | 629055 |
| 3/4" internal thread x 1/2" internal thread | 629075 |
| 3/4" internal thread x 3/4" internal thread | 629077 |

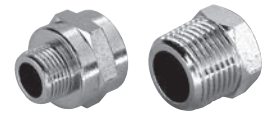

Reduction nipples

| Dimension | Art. No. |
|--------------------------------------|----------|
| 1/8" external x 1/8" internal thread | 622000 |
| 1/8" external x 1/4" internal thread | 622002 |
| 1/8" external x 3/8" internal thread | 622004 |
| 1/8" external x 1/2" internal thread | 622005 |
| 1/4" external x 1/8" internal thread | 622020 |
| 1/4" external x 1/4" internal thread | 622022 |
| 1/4" external x 3/8" internal thread | 622024 |
| 1/4" external x 1/2" internal thread | 622025 |
| 3/8" external x 1/8" internal thread | 622040 |
| 3/8" external x 1/4" internal thread | 622042 |
| 3/8" external x 3/8" internal thread | 622044 |
| 3/8" external x 1/2" internal thread | 622045 |
| 1/2" external x 1/8" internal thread | 622050 |
| 1/2" external x 1/4" internal thread | 622052 |
| 1/2" external x 3/8" internal thread | 622054 |
| 1/2" external x 1/2" internal thread | 622055 |
| 1/2" external x 3/4" internal thread | 622057 |
| 3/4" external x 3/8" internal thread | 622074 |
| 3/4" external x 1/2" internal thread | 622075 |



Tel: 505-550-6501

Fax: 505-814-5778

Email: sales@agstech.net

Web: www.agstech.net

PRIVATE LABEL OPTION

OEM OPTION

We can put your company name, brand....on these.

MADE IN DENMARK